

SPECIFICATION SHEET
Bholanath

STEPPER MOTOR
BH42 SH 33-1334 A
HIGH TORQUE HYBRID

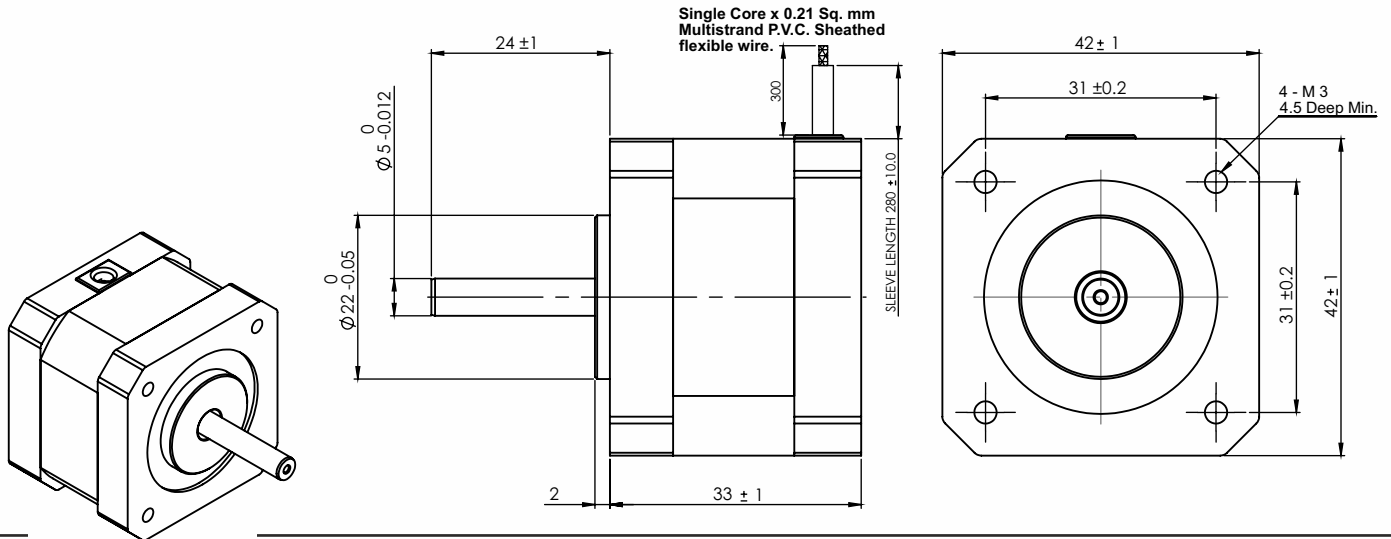

TECHNICAL DATA

CHARACTERISTICS

| |
|--|
| Step Angle - 1.8° |
| Step Angle Accuracy - ± 3 Arc Minute |
| Insulation Class - H |
| Ambient Temperature - - 20°C + 50°C |
| Temperature Rise - 80°C Max. (Rated Current Phase 2 ON) |
| Insulation Resistance 100 M Ohms Min.500 VDC |
| Dielectric Strength 500 VAC For One Minute |
| Shaft Radial Play 0.02 Max. Play (450 G Load) |
| Shaft Axial Play 0.08 Max. Play (450 G Load) |
| Max.Radial Force 28 N (20MM From Front Flange) |
| Max.Axial Force 10 N |

SPECIFICATION

BH42SH33-1334A

| MODEL | Bipolar | |
|----------------------|-------------------|---------|
| 1 Rated Voltage | V | 2.8 |
| 2 Current / Phase | A | 1.33 |
| 3 Resistance / Phase | ± 10% Ω | 2.1 |
| 4 Inductance / Phase | ± 20% mH | 1.6 |
| 5 Holding Torque | Nm | 0.22 |
| 6 Rotor Inertia | G-CM ² | 35 |
| 7 Weight | KG. | 0.27 |
| 8 No of Lead | N ⁰ | 4 |
| 9 Operating Voltage | VDC | 12 - 24 |

Wiring Diagram

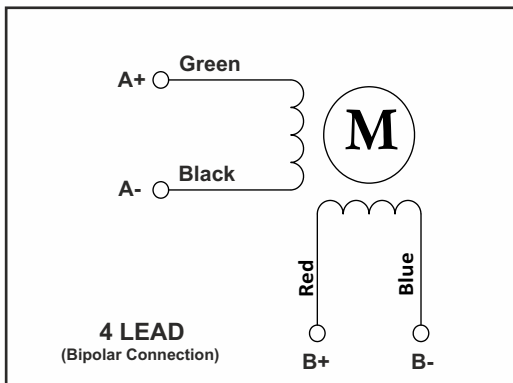

DRIVE SET

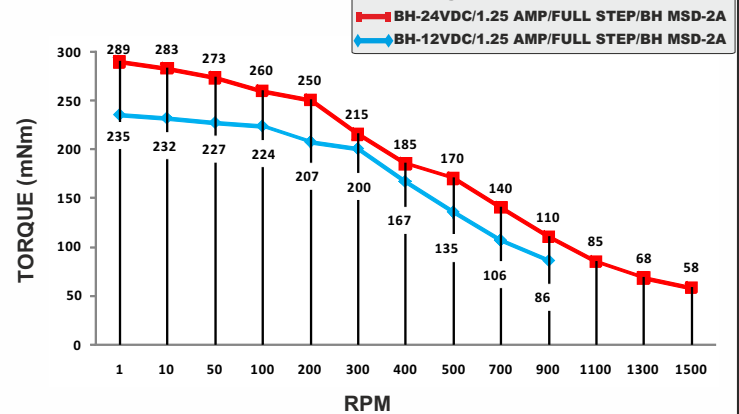

MOTOR MODEL - BH42SH33-1334A



Bholanath Precision Engineering Pvt.Ltd.

11,Kembros Ind.Estate , Sonapur Lane , Bhandup (W),Mumbai - 400078.
Telefax/Phone : 25662856/25664338/67993260 Email : support@bholanath.in
Mobile No : 9920903825/9821671733/9930514603/9819515543/9323166582.