

**SPECIFICATION SHEET**  
**Bholanath**

**STEPPER MOTOR**  
**BH 42 SH 60 - 0854 LA-NC(T6X2)**  
**HIGH TORQUE HYBRID**

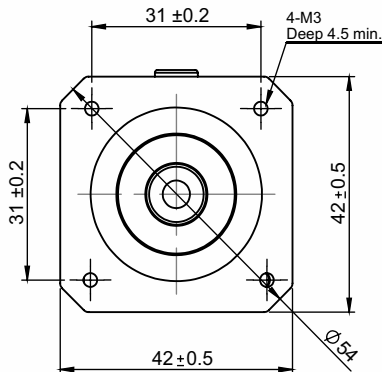

**Front View & Mounting**



Single Core x 0.21 Sq.mm  
Multistrand P.V.C. Sheathed  
flexible wire.

**Side View**

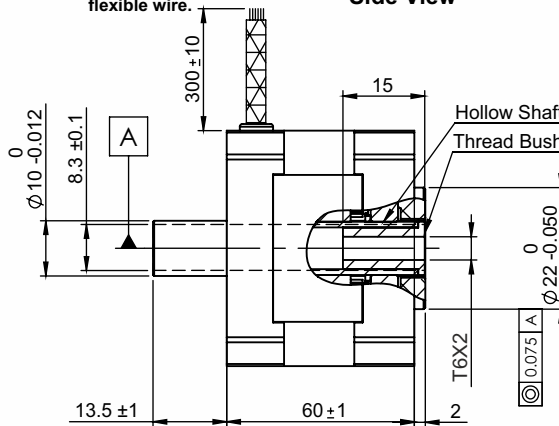

**Rear View**

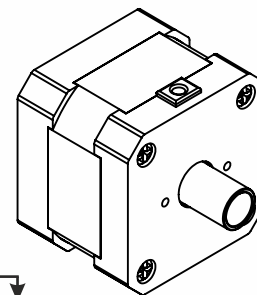
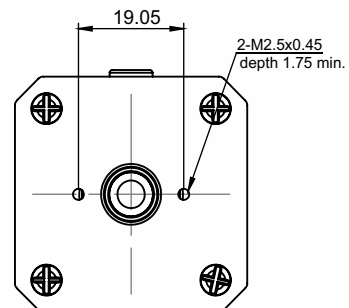

- Screw Length : 200 mm.
- Model Type : Linear Actuator Non Captive Stepper Motor

**TECHNICAL DATA**

**CHARACTERISTICS**

- Step Angle - 1.8°
- Step Angle Accuracy - ± 5%
- Insulation Class - H
- Ambient Temperature - (- 20°C to + 50°C)
- Temperature Rise - 80°C Max. ( Rated Current Phase 2 ON )
- Insulation Resistance 100 M Ohms Min.500 VDC
- Dielectric Strength 500 VAC For One Minute
- Shaft Radial Play 0.02 Max. Play ( 450 G Load )
- Shaft Axial Play 0.08 Max. Play ( 450 G Load )
- Max.Radial Force 28 N ( 20MM From Front Flange )

**SPECIFICATION**

**BH 42 SH 60 - 0854 LA-NC(T6X2)**

MODEL	Bipolar	
1 Rated Voltage	V	10.2
2 Current / Phase	A	0.85
3 Resistance / Phase ± 10%	Ω	12
4 Inductance / Phase ± 20%	mH	18
5 Holding Torque	Nm	0.9
6 Weight	KG.	0.590
7 No of Lead	N°	4
8 Operating Voltage	VDC	24 - 50
9 Linear Step size - 10 micron per full step		

**Wiring Diagram**

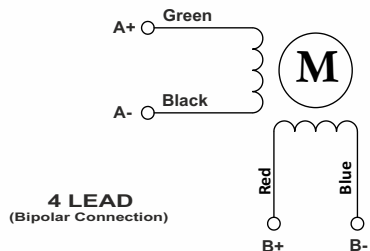

**DRIVE SET**

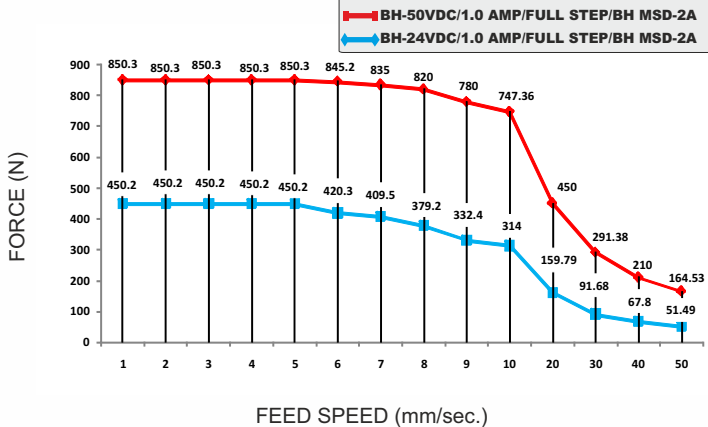

**Bholanath Precision Engineering Pvt.Ltd.**

11,Kembros Ind.Estate , Sonapur Lane , Bhandup (W),Mumbai - 400078.  
Telefax/Phone : 25662856/25664338/67993260 Email : support@bholanath.in  
Mobile No : 9920903825/9821671733/9930514603/9819515543/9323166582.