

**SPECIFICATION SHEET**  
**Bholanath**

**STEPPER MOTOR**  
**BH57 SH 100 - 3004 AK BRK**  
**HIGH TORQUE HYBRID**

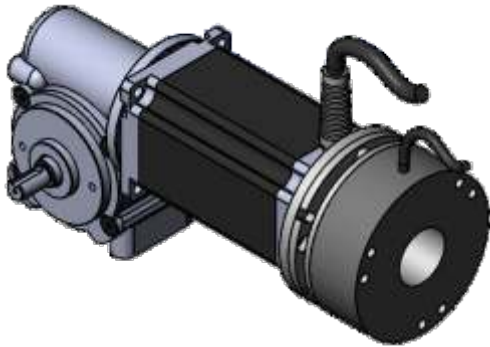
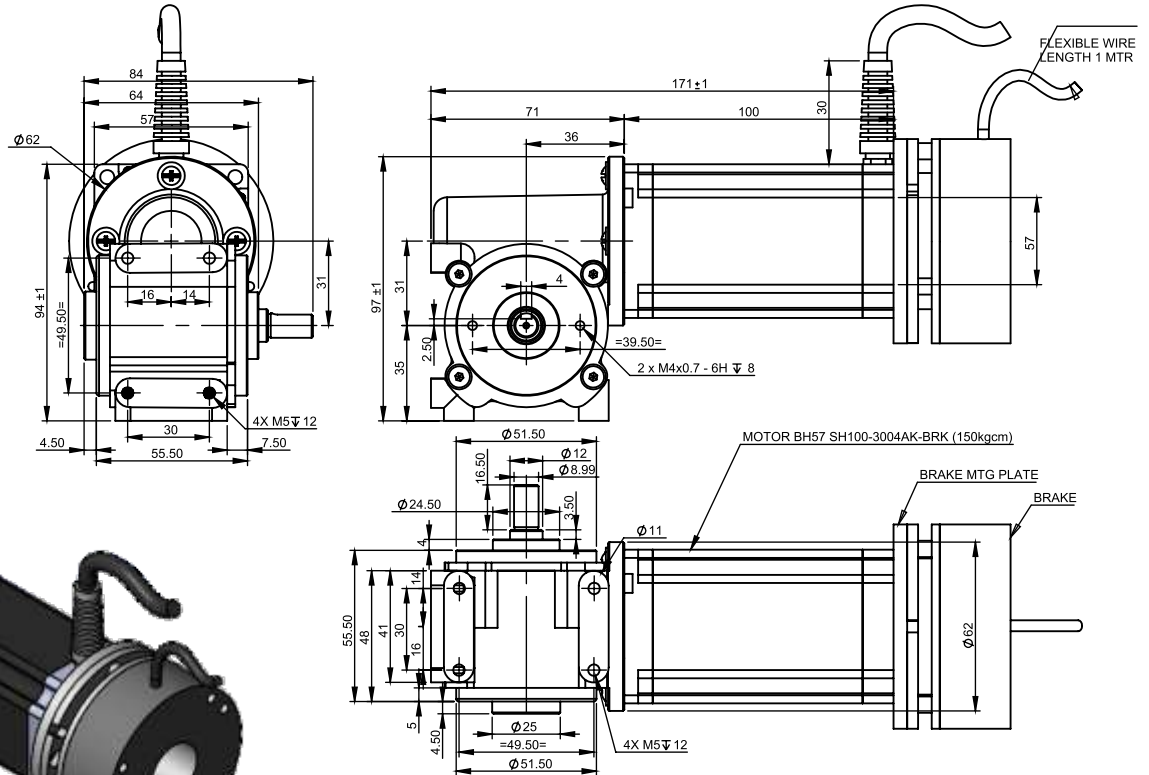

**CHARACTERISTICS**

|  |
|--|
| Motor - Bipolar                                      |
| Steps per Revolution - 200                           |
| Step Angle - 1.8 degree                              |
| Motor Step Angle Accuracy- ± 3 Arc Minute            |
| Dimensions - Refer drawing                           |
| Total Weight - 2.6 Kg                                |
| Insulation Class - Class H                           |
| Protection Class - DIN40050 - Ip30                   |
| Resistance of Insulation - 100MΩ 500 VDC             |
| Resistance per phase - 1.55 / 1.56 Ω                 |
| Inductance per phase - 6.4 / 6.6 mH                  |
| Normal current per phase - 3 Amp                     |
| Operating Voltage - 42 to 48 VDC                     |
| Stock Temperature - (-10°C to +70°C)                 |
| Operation Temperature - (-10°C To 40°C)              |
| Holding Torque for Motor - 2.5 Nm                    |
| Holding Torque With gear Box - 15.0 Nm (150Kgcm)     |
| Shaft Radial Play - 0.02 MmmMax(450 G Load)          |
| Shaft Axial Play - 0.08 MmmMax(450 G Load)           |
| Gear Box Ratio - 8:1                                 |
| Backlash ≤ 0.8 Degree                                |
| Rotor Inertia of Motor 570 - GM CM <sup>2</sup>      |
| Rotor Inertia of Gearbox 144.23 - GM CM <sup>2</sup> |

**Wiring Diagram**

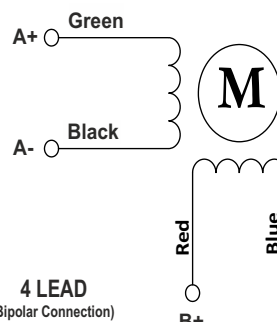

**BRAKE DETAILS :**  
Torque : 3 Nm  
Voltage : 24 V  
Current at 20°C - 0.66 Amps  
Power Consumption at 20°C : 16 Watts

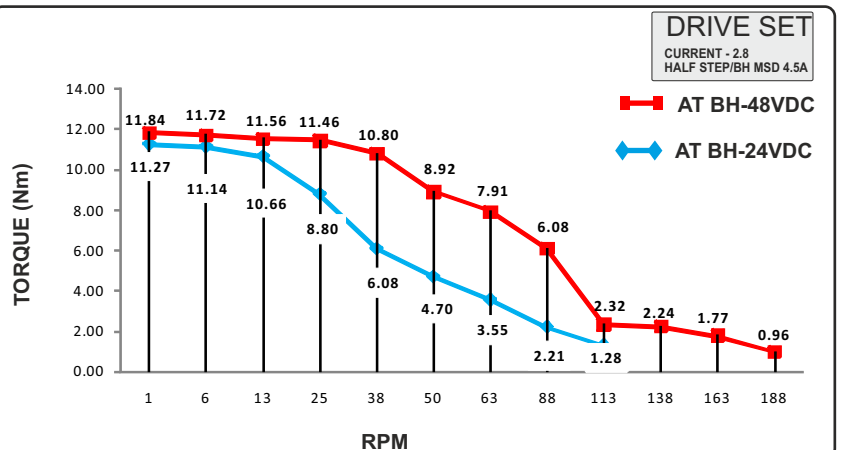
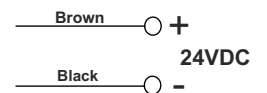

**GEAR BOX STEPPER MOTOR - BH57SH100-3004AK BRK**